

TECHNE®



ROTAX

mechatronic rotary extrusion
blow-moulding machine



TECHNE ROTAX is a mechatronic rotary extrusion and blow moulding machine with an extremely high capability in terms of production and redeployment. The 24 stations allow to reach very high production capacities (more than 30.000 bottles per hour for 250 ml volume) with a high repeatability. Possibly the biggest wheel available on the market, the extremely robust mechanical design offers an absolute reliability to the end user.

The range of products which can be produced on this machine is very wide, from small containers (250 ml to 500 ml) in neck to neck, to medium volumes (1L to 2L) or bigger ones (up to 5L), for food, detergent or lubricants.

In case of small containers, the chord adjustment allows to use appropriate moulds and to limit the production of scrap. The production capacity and efficiency of ROTAX has been tested since 2009 and today, several units are in production with detergent, personal care and food applications, monolayer and multilayer structure, polyethylene and polypropylene products.

Cr Chordal mould lenght	in	20"		19,5"		19"		18,5"		18"	
	mm	508		495,3		482,6		469,9		457,2	
N Cavities number	unit	1	2	1	2	1	2	1	2	1	2
H Maximum bottle height	mm	438	436	426	423	413	410	400	398	388	385
I Centre distance	mm	0	140	0	140	0	140	0	140	0	140
L/Ø Bottle width / diameter	mm	225	105	225	105	225	105	225	105	225	105
C Mould width	mm	304,8	304,8	304,8	304,8	304,8	304,8	304,8	304,8	304,8	304,8
S Maximum bottle thickness	mm	255,6	255,6	255,6	255,6	255,6	255,6	255,6	255,6	255,6	255,6

Cr Chordal mould lenght	in	17,5'		17"		16,5"		16"		15,5"		15"	
	mm	444,5		431,8		419,1		406,4		393,7		381	
N Cavities number	unit	1	2	1	2	1	2	1	2	1	2	1	2
H Maximum bottle height	mm	375	372	362	360	350	347	337	334	324	321	311	309
I Centre distance	mm	0	140	0	140	0	140	0	140	0	140	0	140
L/Ø Bottle width / diameter	mm	225	105	225	105	225	105	225	105	225	105	225	105
C Mould width	mm	304,8	304,8	304,8	304,8	304,8	304,8	304,8	304,8	304,8	304,8	304,8	304,8
S Maximum bottle thickness	mm	255,6	255,6	255,6	255,6	255,6	255,6	255,6	255,6	255,6	255,6	255,6	255,6

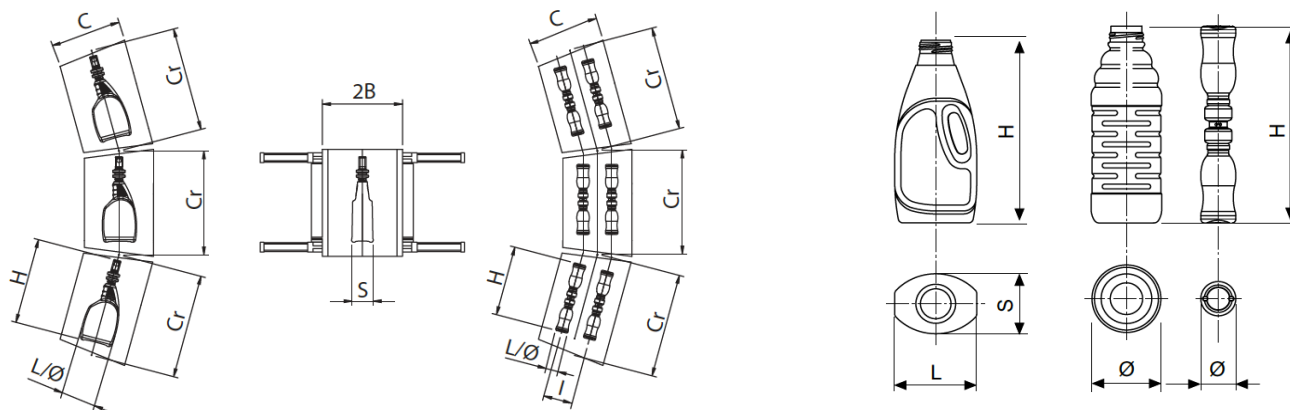

Technical data

Clamping stations	unit	24
Clamping force	kN	75
Max rotating speed	rpm	6
Parison control points	unit	500
Blowing type	def.	needle
Bottle size range	def.	1L to 5L
Electric consumption**	kW/kg	0,27/0,31

**estimate electric consumption in kW per kilo of plastic extruded per hour, monolayer configuration (0,27kW/kg) and 3 layers (0,31 kW/kg).

Material processed

LDPE/HDPE

HMWPE

PP

Extrusion configuration*

Mono

Co-ex 2

Co-ex 3

Co-ex 4

Co-ex 5

Co-ex 6

RX24
rotary machine

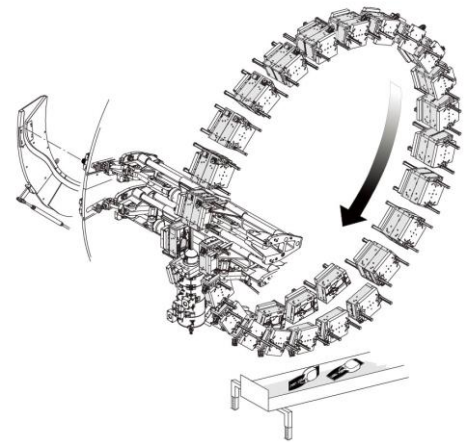

Options / Features

Fast cooling system VELTECH®

Screen changer on extruder

Air conditioned electric cabinets

Window stripe

Product exit conveyor

Neck to neck blowing

Inclined neck blowing

TELETECH® remote assistance

*extruder type and sizes to be defined according to customer needs in terms of production capacity.

RX24
approximate weight 70 tons

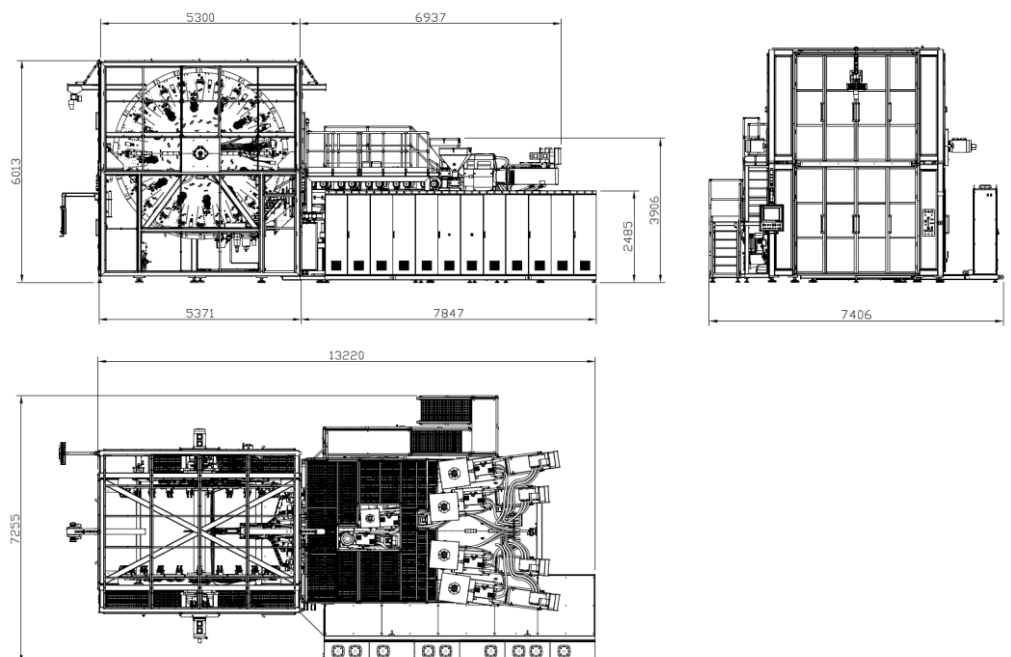
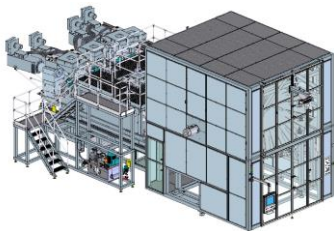

RX24

rotary machine

Production examples:

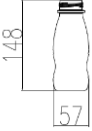
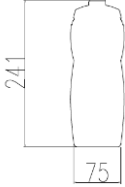
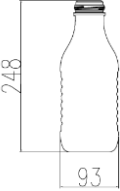
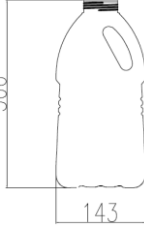
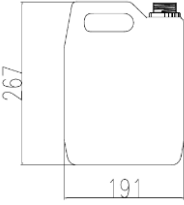
				
148 57	241 75	248 93	306 143	267 191
220 ml	700 ml	1.000 ml	2.500 ml	5.000 ml
net weight 20 g rotation 6 rpm double parison neck to neck	net weight 42 g rotation 5,8 rpm double parison	net weight 29 g rotation 6 rpm double parison	net weight 110 g rotation 3,2 rpm single parison	net weight 190 g rotation 2,3 rpm single parison
RX24: 34.560	RX24: 16.700	RX24: 17.280	RX24: 4.620	RX24: 3.400

Note: indicative production capacity, for moulds manufactured by TECHNE - to be verified case by case based on the weight of container produced and the processed raw material.



TECHNE
Graham Packaging Company Italia Srl
Via della Tecnica 1
40023 Castel Guelfo di Bologna
Italy

www.technespa.com
info@technespa.com
Tel. +39 0542 639901
Fax +39 0542 639963

follow us



reliability

quality

process

expertise

optimization

technology

engineering

